

1. Calculate the area of each place.

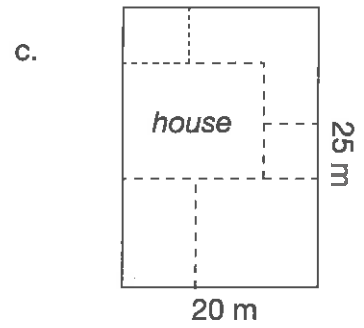
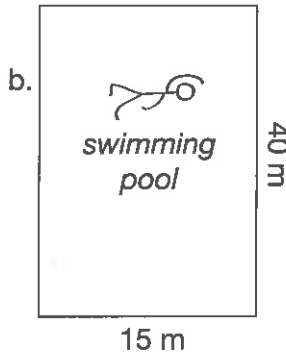
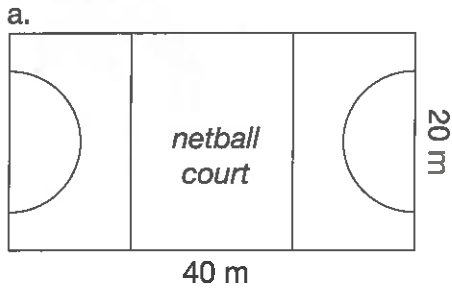

length ___ x width ___ = ___m² length ___ x width ___ = ___m² length ___ x width ___ = ___m²

2. Convert the number of square metres (m²) to hectares (ha).

m ²	1500	2600	5000	7500	9000	10 000	20 000	50 000
ha								

3. Calculate the area of the three paddocks on Tom's property.

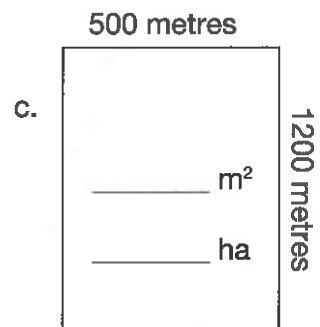
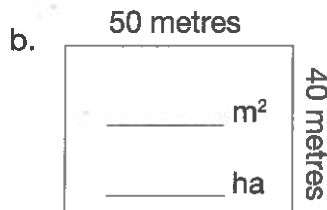
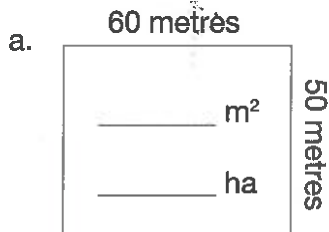

4. The number of square kilometres for each state of Australia is listed. Order the states from the state with the smallest area to the state with the largest area.

Queensland 1 723 936 km² _____

New South Wales 802 000 km² _____

Victoria 227 600 km² _____

Tasmania 64 519 km² _____

South Australia 984 400 km² _____

Northern Territory 1 349 129 km² _____

Western Australia 2 525 500 km² _____

